

Environmental Data

		SGT	SGR
Light immunity @ 5° incidence		-	100 000 lux
Temperature, operation		-20 to +65 °C	
Temperature, storage		-40 to +80 °C	
Sealing class	A / B housing	IP 54	
	C housing	IP 67	
Approvals		CE UK CA	

Available Types

Slim Line A

	Housing Length	Active Height	Number of Channels	Number of Beams	Beam Spacing	Connection		3 m flexible cable	Range
						Output	Order Reference		
Transmitter	850 mm	650 mm	8	34	92 mm	-	-	SGT 1-085-008-B1-A-00-3F	4 m
		695 mm	16	74	46 mm			SGT 1-085-016-A1-A-00-3F	
	1250 mm	1020 mm	12	54	92 mm			SGT 1-125-012-B1-A-00-3F	
		1065 mm	24	114	46 mm			SGT 1-125-024-A1-A-00-3F	
	1600 mm	1385 mm	16	74	92 mm			SGT 1-160-016-B1-A-00-3F	
		1430 mm	32	154	46 mm			SGT 1-160-032-A1-A-00-3F	
	2000 mm	1755 mm	20	94	92 mm			SGT 1-200-020-B1-A-00-3F	
		1800 mm	40	194	46 mm			SGT 1-200-040-A1-A-00-3F	
	2100 mm	1755 mm	20	94	92 mm			SGT 1-210-020-B1-A-00-3F	
		1800 mm	40	194	46 mm			SGT 1-210-040-A1-A-00-3F	

	Housing Length	Active Height	Number of Channels	Number of Beams	Beam Spacing	Solid State Relay	Connection		Range
							Output	Order Reference	
Receiver	850 mm	650 mm	8	34	92 mm	Solid State Relay	DO (NO)	SGR 1-085-008-B1-A-04-3F	0-4 m
		695 mm	16	74	46 mm		LO (NC)	SGR 1-085-008-B1-A-05-3F	
	1250 mm	1020 mm	12	54	92 mm		DO (NO)	SGR 1-085-016-A1-A-04-3F	
		1065 mm	24	114	46 mm		LO (NC)	SGR 1-085-016-A1-A-05-3F	
	1600 mm	1385 mm	16	74	92 mm		DO (NO)	SGR 1-125-012-B1-A-04-3F	
		1430 mm	32	154	46 mm		LO (NC)	SGR 1-125-012-B1-A-05-3F	
	2000 mm	1755 mm	20	94	92 mm		DO (NO)	SGR 1-125-024-A1-A-04-3F	
		1800 mm	40	194	46 mm		LO (NC)	SGR 1-125-024-A1-A-05-3F	
	2100 mm	1755 mm	20	94	92 mm		DO (NO)	SGR 1-160-016-B1-A-04-3F	
		1800 mm	40	194	46 mm		LO (NC)	SGR 1-160-016-B1-A-05-3F	
	2000 mm	1755 mm	20	94	92 mm		DO (NO)	SGR 1-160-016-B1-A-05-3F	
		1800 mm	40	194	46 mm		LO (NC)	SGR 1-160-016-B1-A-04-3F	
	2000 mm	1755 mm	20	94	92 mm		DO (NO)	SGR 1-160-032-A1-A-04-3F	
		1800 mm	40	194	46 mm		LO (NC)	SGR 1-160-032-A1-A-05-3F	
	2000 mm	1755 mm	20	94	92 mm		DO (NO)	SGR 1-200-020-B1-A-04-3F	
		1800 mm	40	194	46 mm		LO (NC)	SGR 1-200-020-B1-A-05-3F	
2100 mm	1755 mm	20	94	92 mm	DO (NO)	SGR 1-200-040-A1-A-04-3F			
	1800 mm	40	194	46 mm	LO (NC)	SGR 1-200-040-A1-A-05-3F			
2100 mm	1755 mm	20	94	92 mm	DO (NO)	SGR 1-210-020-B1-A-04-3F			
	1800 mm	40	194	46 mm	LO (NC)	SGR 1-210-020-B1-A-05-3F			
2100 mm	1755 mm	20	94	92 mm	DO (NO)	SGR 1-210-040-A1-A-04-3F			
	1800 mm	40	194	46 mm	LO (NC)	SGR 1-210-040-A1-A-05-3F			

Note: 1. The transmitter SGT and receiver SGR set must have the same number of channels and beam spacing.
 2. The transmitter SGT is available in a long range model to be used in conjunction with standard receiver SGR. Sensing range is increased by 50%.
 Add "H" after the series number of the SGT for long range model, e.g. SGT 1H-200-040-A1-A-00-3F.

Available Types

Leading Edge B

	Housing Length	Active Height	Number of Channels	Number of Beams	Beam Spacing	Connection		3 m flexible cable	Range
							Output	Order Reference	
Transmitter	850 mm	650 mm	8	34	92 mm	-	-	SGT 1-085-008-B1-B-00-3F	3 m
		695 mm	16	74	46 mm			SGT 1-085-016-A1-B-00-3F	
	1250 mm	1020 mm	12	54	92 mm			SGT 1-125-012-B1-B-00-3F	
		1065 mm	24	114	46 mm			SGT 1-125-024-A1-B-00-3F	
	1600 mm	1385 mm	16	74	92 mm			SGT 1-160-016-B1-B-00-3F	
		1430 mm	32	154	46 mm			SGT 1-160-032-A1-B-00-3F	
	2000 mm	1755 mm	20	94	92 mm			SGT 1-200-020-B1-B-00-3F	
		1800 mm	40	194	46 mm			SGT 1-200-040-A1-B-00-3F	
	2100 mm	1755 mm	20	94	92 mm			SGT 1-210-020-B1-B-00-3F	
		1800 mm	40	194	46 mm			SGT 1-210-040-A1-B-00-3F	

	Housing Length	Active Height	Number of Channels	Number of Beams	Beam Spacing	Solid State Relay	Connection		Range
								Output	
Receiver	850 mm	650 mm	8	34	92 mm	Solid State Relay	DO (NO)	SGR 1-085-008-B1-B-04-3F	0-3 m
		695 mm	16	74	46 mm		LO (NC)	SGR 1-085-008-B1-B-05-3F	
	1250 mm	1020 mm	12	54	92 mm		DO (NO)	SGR 1-085-016-A1-B-04-3F	
		1065 mm	24	114	46 mm		LO (NC)	SGR 1-085-016-A1-B-05-3F	
	1600 mm	1385 mm	16	74	92 mm		DO (NO)	SGR 1-125-012-B1-B-04-3F	
		1430 mm	32	154	46 mm		LO (NC)	SGR 1-125-012-B1-B-05-3F	
	2000 mm	1755 mm	20	94	92 mm		DO (NO)	SGR 1-125-024-A1-B-04-3F	
		1800 mm	40	194	46 mm		LO (NC)	SGR 1-125-024-A1-B-05-3F	
	2100 mm	1755 mm	20	94	92 mm		DO (NO)	SGR 1-160-016-B1-B-04-3F	
		1800 mm	40	194	46 mm		LO (NC)	SGR 1-160-016-B1-B-05-3F	
	2000 mm	1755 mm	20	94	92 mm		DO (NO)	SGR 1-160-032-A1-B-04-3F	
		1800 mm	40	194	46 mm		LO (NC)	SGR 1-160-032-A1-B-05-3F	
	2000 mm	1755 mm	20	94	92 mm		DO (NO)	SGR 1-200-020-B1-B-04-3F	
		1800 mm	40	194	46 mm		LO (NC)	SGR 1-200-020-B1-B-05-3F	
	2100 mm	1755 mm	20	94	92 mm		DO (NO)	SGR 1-200-040-A1-B-04-3F	
		1800 mm	40	194	46 mm		LO (NC)	SGR 1-200-040-A1-B-05-3F	
	2100 mm	1755 mm	20	94	92 mm		DO (NO)	SGR 1-210-020-B1-B-04-3F	
		1800 mm	40	194	46 mm		LO (NC)	SGR 1-210-020-B1-B-05-3F	
	2100 mm	1755 mm	20	94	92 mm		DO (NO)	SGR 1-210-040-A1-B-04-3F	
		1800 mm	40	194	46 mm		LO (NC)	SGR 1-210-040-A1-B-05-3F	

Note: 1. The transmitter SGT and receiver SGR set must have the same number of channels and beam spacing.
 2. The transmitter SGT is available in a long range model to be used in conjunction with standard receiver SGR. Sensing range is increased by 50%.
 Add "H" after the series number of the SGT for long range model, e.g. SGT 1H-200-040-A1-B-00-3F.

Available Types

Slim Line C

Transmitter	Housing Length	Active Height	Number of Channels	Number of Beams	Beam Spacing	Connection		3 m flexible cable	Range
						Output		Order Reference	
	850 mm	650 mm	8	34	92 mm	-	-	SGT 1-085-008-B1-C-00-3F	4 m
		695 mm	16	74	46 mm			SGT 1-085-016-A1-C-00-3F	
	1250 mm	1020 mm	12	54	92 mm			SGT 1-125-012-B1-C-00-3F	
		1065 mm	24	114	46 mm			SGT 1-125-024-A1-C-00-3F	
	1600 mm	1385 mm	16	74	92 mm			SGT 1-160-016-B1-C-00-3F	
		1430 mm	32	154	46 mm			SGT 1-160-032-A1-C-00-3F	
	2000 mm	1755 mm	20	94	92 mm			SGT 1-200-020-B1-C-00-3F	
		1800 mm	40	194	46 mm			SGT 1-200-040-A1-C-00-3F	

Receiver	Housing Length	Active Height	Number of Channels	Number of Beams	Beam Spacing	Solid State Relay	Connection		Range
							DO (NO)	LO (NC)	
	850 mm	650 mm	8	34	92 mm		DO (NO)	SGR 1-085-008-B1-C-04-3F	0-4 m
		695 mm	16	74	46 mm		LO (NC)	SGR 1-085-008-B1-C-05-3F	
	1250 mm	1020 mm	12	54	92 mm		DO (NO)	SGR 1-125-012-B1-C-04-3F	
		1065 mm	24	114	46 mm		LO (NC)	SGR 1-125-012-B1-C-05-3F	
	1600 mm	1385 mm	16	74	92 mm		DO (NO)	SGR 1-125-024-A1-C-04-3F	
		1430 mm	32	154	46 mm		LO (NC)	SGR 1-125-024-A1-C-05-3F	
	2000 mm	1755 mm	20	94	92 mm		DO (NO)	SGR 1-160-016-B1-C-04-3F	
		1800 mm	40	194	46 mm		LO (NC)	SGR 1-160-016-B1-C-05-3F	
						DO (NO)	SGR 1-160-032-A1-C-04-3F		
						LO (NC)	SGR 1-160-032-A1-C-05-3F		
						DO (NO)	SGR 1-200-020-B1-C-04-3F		
						LO (NC)	SGR 1-200-020-B1-C-05-3F		
						DO (NO)	SGR 1-200-040-A1-C-04-3F		
						LO (NC)	SGR 1-200-040-A1-C-05-3F		

- Note:** 1. The transmitter SGT and receiver SGR set must have the same number of channels and beam spacing.
 2. The transmitter SGT is available in a long range model to be used in conjunction with standard receiver SGR. Sensing range is increased by 50%. Add "H" after the series number of the SGT for long range model, e.g. SGT 1H-200-040-A1-C-00-3F.

Wiring Diagrams

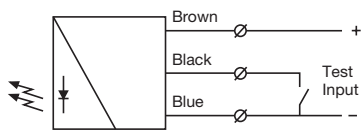

SGT 1

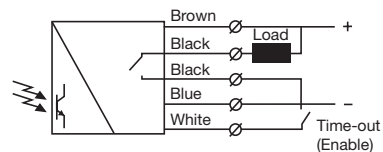

SGR 1
Load as NPN

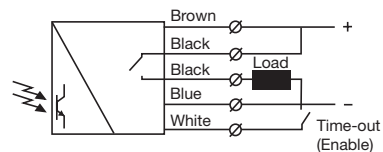

SGR 1
Load as PNP

Dimensions and Descriptions

Slim Line A

Details

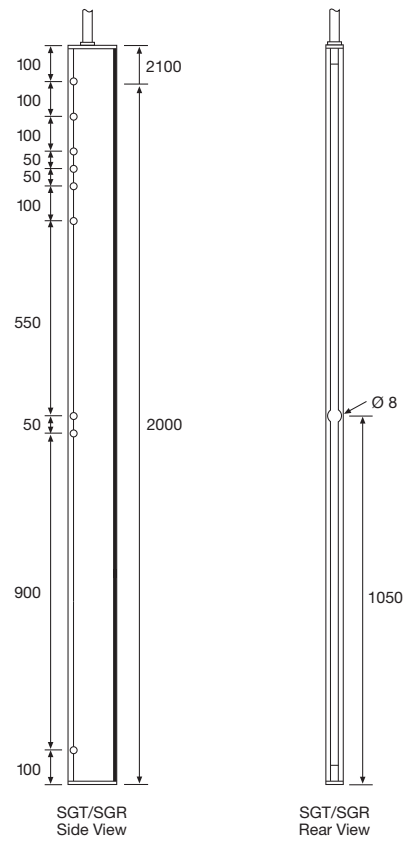
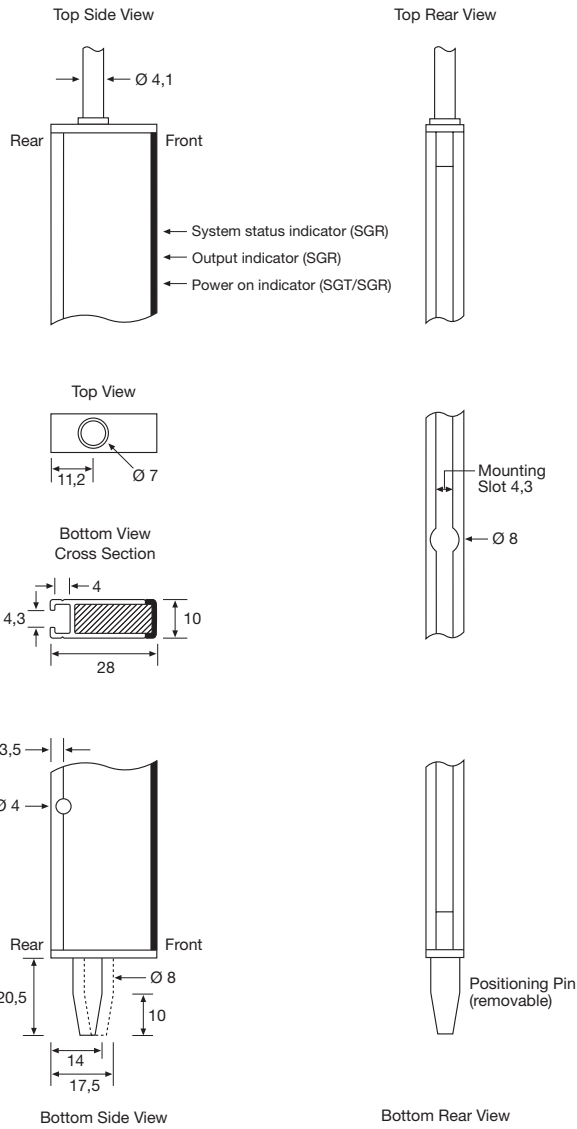

SGT/SGR 1-200/210

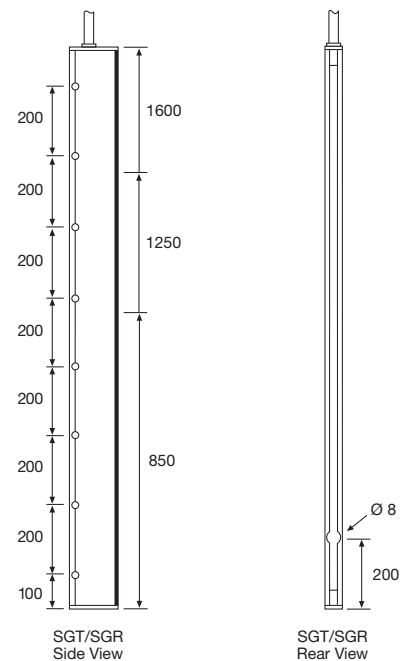

SGT/SGR 1-085/125/160

(Units in mm)

Dimensions and Descriptions

Leading Edge B

Details

SGT
Top Front View
(shown with screw cover strip)

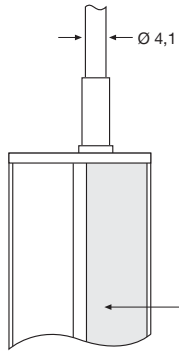

SGR
Top Front View
(shown without screw cover strip)

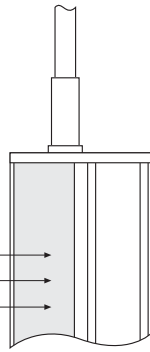

System status indicator
Output indicator
Power on indicator

Top View

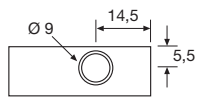

Top View

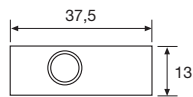

Bottom View
Cross Section

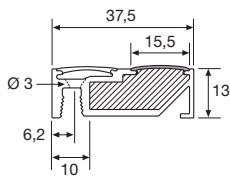

Bottom View
Cross Section

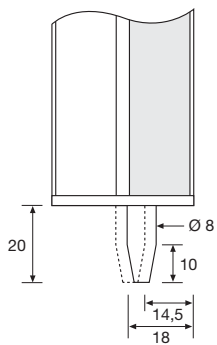
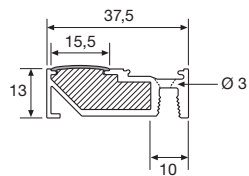

Bottom Front View

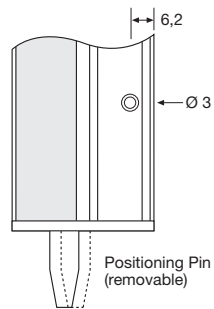

Bottom Front View

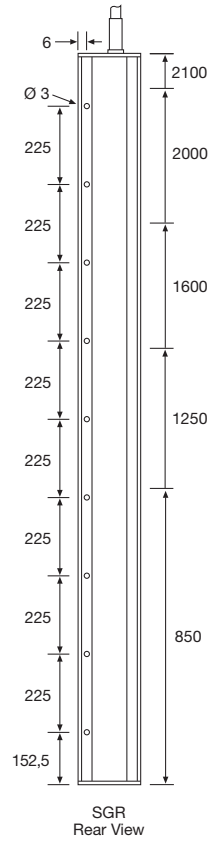

SGR
Rear View

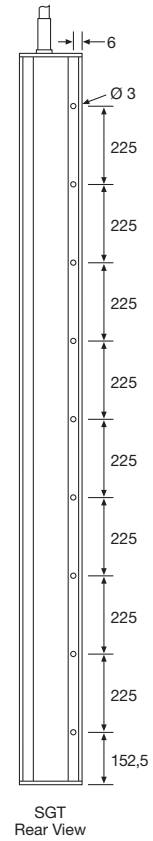

SGT
Rear View

(Units in mm)

Beam Patterns

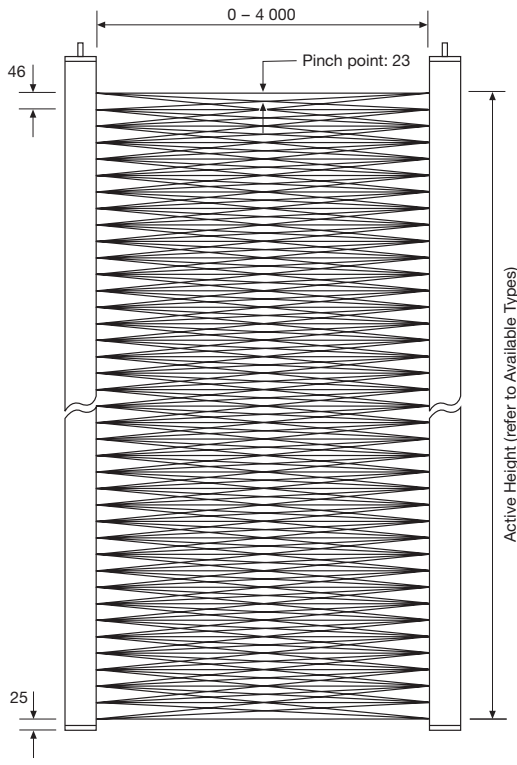

46 mm channel spacing

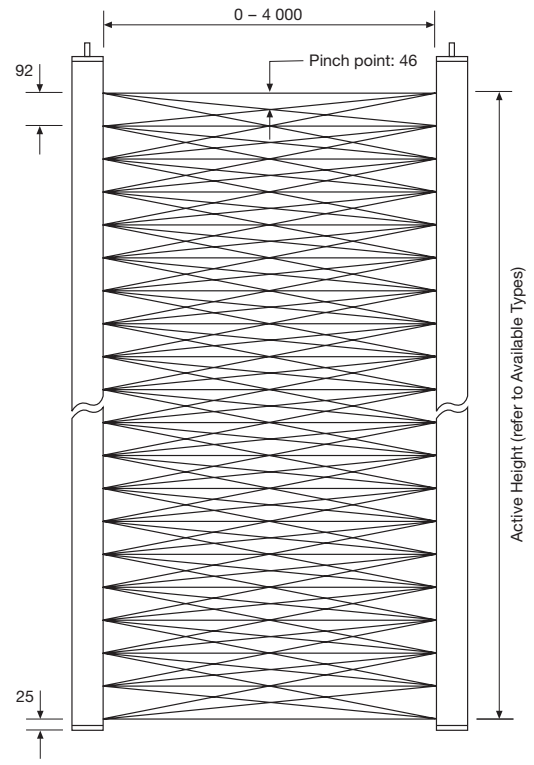

92 mm channel spacing

(Units in mm)

Sensing Characteristics

Parallel Displacement

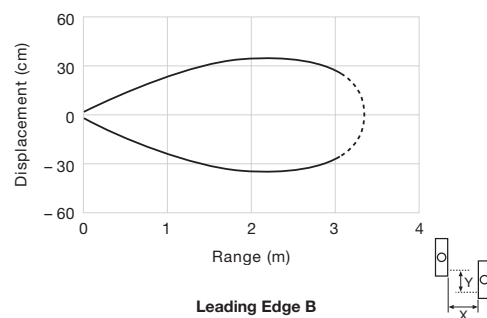
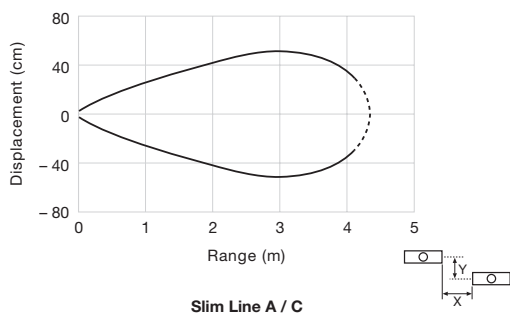

Telco reserves the right to change specifications without notice.